



SHIRE OPENING HOURS

8.30am to 4.30pm
Weekdays (closed
Public Holidays)

Licensing Closes 4pm

NEXT COUNCIL MEETING

21 April 2021

Ordinary Council
Meeting
commencing 2pm

TIP HOURS

7.30am - 4.00pm
Saturday - Monday

POOL HOURS

Currently closed until
the 2021-22 season

RANGER CONTACT

24 hours / 7 days
Ph: 0459 678 154

WASTE COLLECTION

Every Tuesday

RECYCLING DATES

18 May and
1 June 2021

MEMORIAL PARK REDEVELOPMENT



The Memorial Park Redevelopment has been running smoothly over the past two months with minimal disruptions.

The most noticeable change has been the installation of nature play equipment following the completion of earthworks at the site. The limestone wall along the western boundary (abutting the Play Group) has also taken shape.

During the next fortnight, concrete works will commence which will form the footpath network throughout the precinct. Furniture and additional play items will also arrive and continue to be installed to form the junior, children and nature play spaces. Various utility functions will be undertaken including plumbing, drainage and electrical works.

The project remains on schedule for completion by 30 June 2021. Full colour pictures are available to view from the Shire's website and Facebook page.





TOWN HALL CONCEPT PLAN

The Shire of Pingelly is inviting residents to comment on the first stage of the Town Hall Concept Plan, following an initial period of community engagement and concept development. In September 2020, Council considered the future use of the Pingelly Town Hall following a number of community workshops. The final report from these workshops outlined three options for the Town Hall, being:



1. Undertake community based historical projects to capture and display the Town's diverse history on the wall spaces and potentially the stage area, utilising photos, physical displays and audio-visual displays. Ensure that these displays are regularly rotated to provide variety and ongoing dialogue for residents, visitors and tourists. Likely initial displays are War Portraits, selected historical records, aboriginal culture/history and an agricultural display.
2. A flexible space in the central hall component focused on rotations of art / craft workshops, additional historical displays, community pop up markets and stalls, tourism events and potentially the ANZAC day service.
3. Incorporate a Tourism / Visitors Centre at the front of the Hall in a converted kitchen space.

The multi-purpose use of the Pingelly Town Hall was approved by Council in accordance with the community led direction, and subsequently, a Town Hall Reference Group (THRG) was formed, with representation from the Pingelly Tourism Group, Museum Group, Arts and Craft Group, Council and general community.

The initial role of the Reference Group was to develop a Concept Plan for the Pingelly Town Hall that allowed the space to be utilised in a way that incorporated all of the three uses identified by the community. Architects from the Office of Regional Architecture assisted the THRG to develop a concept that reflected the community aspirations outlined during the extensive consultation undertaken in 2020/21.

Stage 1 of this project proposes the creation of a visitors area, which will be the go-to place for tourists and visitors to the town in order to help them make the most of their stay. This stage involves opening the front section of the Hall by combining the current kitchen area and foyer, to create a large usable open space. Specific items included in the first stage include:

- Removal of the non-structural wall between the entry hall and the kitchen to create an open plan visitor space.
- Remove and replace flooring in the new visitor space.
- Install fitout to new visitor space, including display shelving.
- Improve access to the main Hall entry.
- Air-conditioning within the new visitor space.
- Removal of kitchen equipment and fitout within current kitchen space.
- Prepare, patch and paint walls and ceilings.
- Install doors on the entry to the existing toilet facilities.



The Town Hall Reference Group members (L to R):

Elizabeth Trump, Jeanette Jeffries, Bronwyn Parker, Jo Booth, Tracey Watts, Julie Burton, Merv Beard, Bill Mulrone.

The Group has met regularly since January 2021 to work through the ideas from the community consultation period and transform them into a workable concept.

A vacancy remains on the Group for an Aboriginal Community Representative. Please contact the Shire for further details.

TOWN HALL CONCEPT PLAN: HAVE YOUR SAY!

The project is considered an important aspect of growing Pingelly's attraction as a tourist destination. A lack of easily accessible information and amenities are a tourism inhibitor, and this directly impacts the capacity to grow the tourism industry. The plan is intended to boost tourism, support the Council's aspiration around job creation, assist with growth in the local economy, as well as utilise the historic building for an active and vibrant purpose.

The initial focus is on Stage 1, as it represents an achievable outcome over the short to medium term. It is anticipated that the ultimate concept plan will only be enacted once Stage 1 is functioning to its full capacity, and there is a further need to expand the spaces within the existing Hall. At this time, further community consultation will occur.

The Shire is currently seeking your input on the first Stage of this development. The engagement period is now open, and will close on 21 May 2021.

Written submissions on the Concept Plan—Stage 1 can be:

Emailed to admin@pingelly.wa.gov.au

Posted to the Shire of Pingelly, 17 Queen Street, Pingelly 6308

Hand delivered to the Shire Administration at 17 Queen Street Pingelly.

For further enquires in relation to this project, please contact Julie Burton, Chief Executive Officer on 9887 1066, or via email julie.burton@pingelly.wa.gov.au.

A full copy of the concept plan is attached to this week's Shire News.

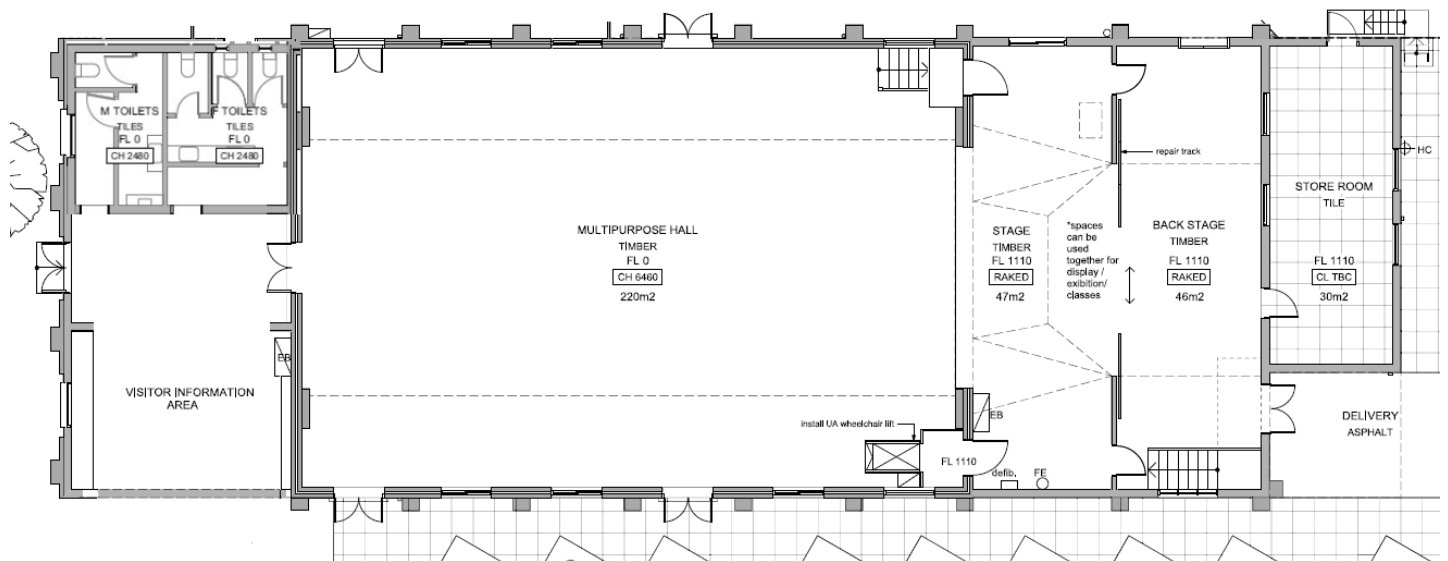

INVITATIONS FOR NATIONAL VOLUNTEER WEEK DISTRIBUTED

As announced last month, the Shire of Pingelly has been successful in securing support from Volunteering WA and Lotterywest to treat our local volunteers (also known as our community champions!) to a sundowner event at the Pingelly Recreation and Cultural Centre later this month.

This week all community groups and sporting clubs on the Shire's contact list have been emailed an invitation to RSVP. The Community Champion Sundowner is a closed-invite event for volunteers aligned with a community group, sporting club or not for profit organisation based within the Shire of Pingelly.

For further information see the flyer attached to this week's Shire News, or contact Sam Kempton, Community Development Officer on 9887 1066 or sam.kempton@pingelly.wa.gov.au



APRIL COUNCIL MEETING HIGHLIGHTS

Annual Electors Meeting – Motion for Council Consideration

At the recent Annual Electors meeting held on 24 March 2021, Council was asked, on behalf of ratepayers, to request the PRACC Board further

investigate options of displaying the Honour Boards within the PRACC building.



Review of Strategic Community Plan

Council endorsed a minor review of the Strategic Community Plan 2020-2030. These minor changes included an increased focus on youth engagement and retention, and also noted the concern around the supply of water for future development, agricultural and community infrastructure purposes.

Town Hall Concept Plan

Council endorsed the proposed redevelopment concept plan for the Town Hall for the purposes of Community Consultation. The concept plan has been developed in conjunction with the Town Hall Reference Group.

Chief Executive Officer – Recruitment

The Chief Executive Officer Job Description was presented to Council for approval. Council also approved the appointment of Mr Alan Hodges to the Selection Panel for the new Chief Executive Officer, in accordance with recent changes to legislation which require an independent person to form part of the Panel.

Code of Conduct for Council Members, Committee Members and Candidates

Council formally adopted a new Code of Conduct that is now mandated under amended State Government legislation. A copy of this is now available on the Shire's website [Code of Conduct](#) » Shire of Pingelly.

Policy Amendment – Senior Staff Designation and Appointment of Acting Chief Executive Officer

Council reviewed its policy relating to Senior Staff Designation and Appointment of Acting Chief Executive Officer with no major changes.

Pingelly Swimming Pool – Contract for Management Services

Council accepted the quote from Contract Aquatic Services for the running of the swimming pool until 2024. Contract Aquatic Services have been providing these services to the Shire since 2009.

WICKEPIN-PINGELLY ROAD PROGRESSES TO FINAL STAGE





EARLY PAYMENT OF RATES PRIZE SPONSORSHIP

The Shire of Pingelly is calling for expressions of interest for the sponsorship of our Early Payment of Rates prizes.

In return for sponsorship, your business will receive significant exposure within the community with over 700 ratepayers and households.

To express your interest, or for more information, please contact Katie Rigg, Customer Service Officer on 9887 1066 or katie.rigg@pingelly.wa.gov.au

COUNCIL DINNER CATERING EXPRESSIONS OF INTEREST

The Shire of Pingelly is seeking applications from local community groups or clubs to cater Shire Council Meeting dinners for the 2021-22 financial year. Council Meetings are held on the third Wednesday of each month excluding December (the second Wednesday) and January (no meeting). Organisations interested in applying are encouraged to submit their expression of interest in writing to the Shire by Friday 4 June 2021.

To register your interest, or for more information, contact Vanessa Ward, Executive Assistant on 9887 1066 or vanessa.ward@pingelly.wa.gov.au.

CURRENT EMPLOYMENT OPPORTUNITIES

The Shire of Pingelly currently is seeking an experienced **Customer Service Officer** on a casual relief basis, as well as **two (2) Plant Operators / Labourers** to join the Works team on a casual basis.

Potential applicants are encouraged to apply as soon as possible, as applications will be assessed on an ongoing basis until a candidate is appointed.

For more information, see the job advertisements attached to this week's Shire News.



LICENSING FOR HIGH SCHOOL STUDENTS

The Shire of Pingelly's licensing operating hours are from 8.30am to 4pm, with a cut off time of 3.30pm for CTT's and HPT's. We understand for high school students it can be difficult to make an appointment during these hours.

Students are welcome to book a time after 4pm by contacting the Shire office and confirming a suitable date and time in advance. The staff member will let you know of the requirements ahead of time to help you prepare for your test. When no bookings after 4pm are received, licensing will close at the usual time of 4pm.